

面板开孔  
Panel Opening

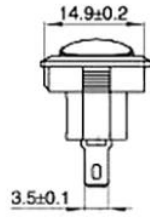

项目 Item	参数 Parameter
额定电流、电压 Rated voltage Rated current	3A 250V AC 6A 125V AC
绝缘电阻 Insulated resistance	$\geq 100M \Omega$
接触电阻 Contact resistance	$\leq 50m \Omega$
介电强度(极间) Dielectric strength	1500VAC/5S
电器寿命 Endurance	$\geq 10000$ Cycles
使用温度 Ambient temperature	T 85

电路图  
Circuit diagram

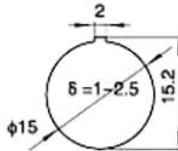
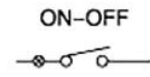
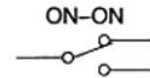
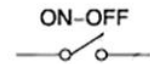

端子规格  
Terminal

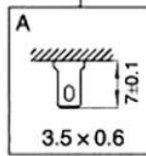

## Opening 15MM Specification