

MTS SERIES

MASSUSE SWITCH

Ordering information

MTS- 102- A 1

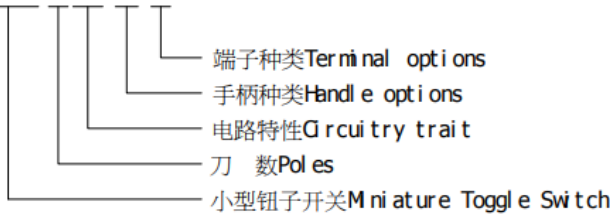

技术特性 Specification:

- 1.规格 Rating: 6A 125VAC: 3A 250VAC
- 2.接触电阻 Contact Resistance: 20mΩmax.
- 3.绝缘电阻 Insulation Resistance: 500VDC 1000MΩmin.
- 4.耐电压 Dielectric strength: 1500VAC, 1Minute
- 5.操作温度 Operating Temperature: -55°C ~ +85°C
- 6.电气寿命 Electrical Life: 20,000 Cycles

电路特性 Circuitry trait

手柄套 Toggle cap(D)

基座颜色 Base color

型号 Model No	Circuitry trait			类型 Type	端子数 Terminals
MTS-101	NO		OFF	SPST	2P
MTS-102	ON	-	ON	SPDT	3P
MTS-102	ON	-	(ON)	SPDT	3P
MTS-103	ON	OFF	ON	SPDT	3P
MTS-103	ON	OFF	ON	SPDT	3P
MTS-103	(ON)	OFF	(ON)	SPDT	3P

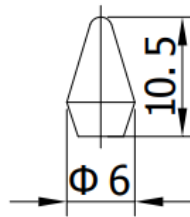

颜色 COLOR

- 黑 Black
- 白 White
- 红 Red
- 黄 Yellow
- 绿 Green
- 兰 Blue

兰 Blue

- 黑 Black
- 红 Red
- 绿 Green

型号 Model No	Circuitry trait			类型 Type	端子数 Terminals
MTS-201	ON	-	OFF	DPST	4P
MTS-202	ON	-	ON	DPDT	6P
MTS-202	ON	-	(ON)	DPDT	6P
MTS-203	ON	OFF	ON	DPDT	6P
MTS-203	ON	OFF	(ON)	DPDT	6P
MTS-203	(ON)	OFF	(ON)	DPDT	6P

防水帽 Water proof cap

WPC-04

M6×0.75

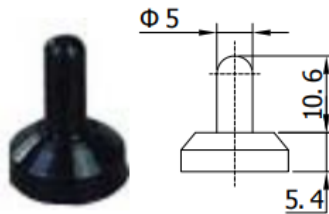

WPC-05

M6×0.75

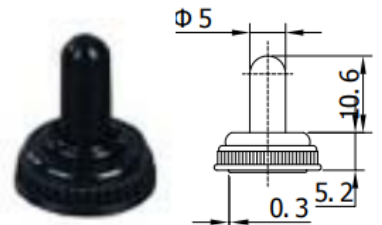

(回弹指示 Indicates Momentary)

手柄种类 Handle options

标准 Standard(A) 矩型 Short(C) 大型 Grand(G) 特大型 large(L) 塑料扁柄 Plastic Flat(E) 金属扁柄 Metal Flat(F)

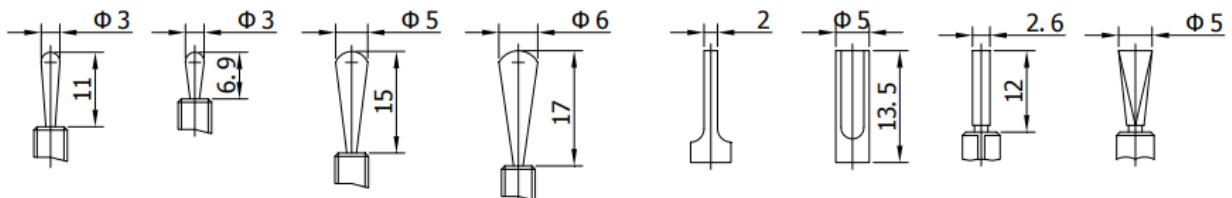

端子种类 Terminal options

Soleer terminal(1)

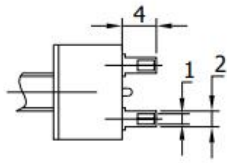

PC terminal(2)

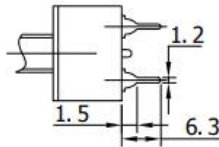

PC-H terminal(3)

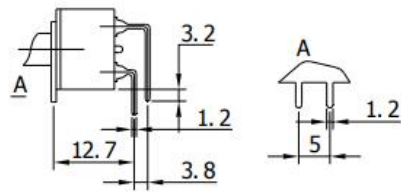

PC-V terminal(4)

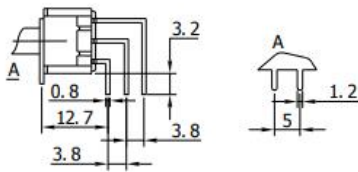

Long Solder terminal(5)

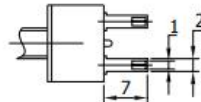

附属配件 Affix Annex

标牌 Nameplate

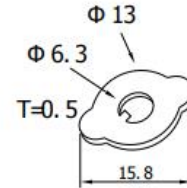

(1)	ON	-	OFF
(2)	ON	-	ON
(3)	ON	OFF	ON

MTS-101 ON-OFF

SPST 2P

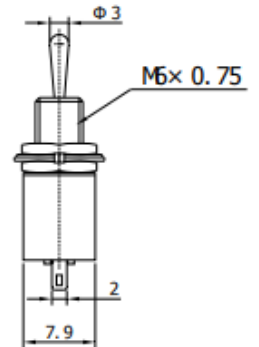
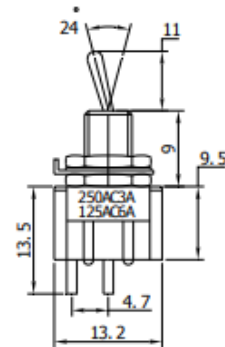
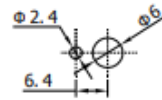

MTS-102 ON-ON

MTS-112 ON-(ON)

MTS-103 ON-OFF-ON

MTS-113 ON-OFF-(ON)

MTS-123 (ON)-OFF-(ON)

MTS-1033 ON-ON-ON

SPDT 3P

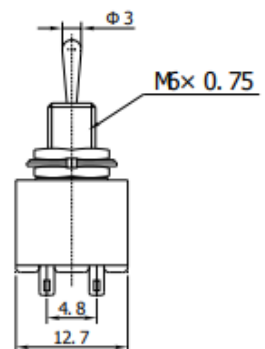
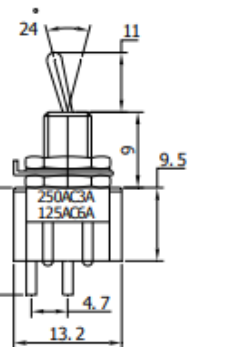
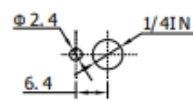
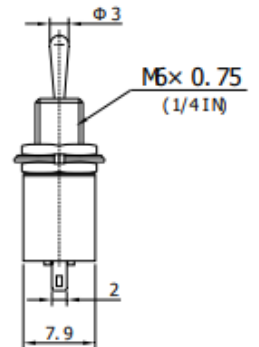
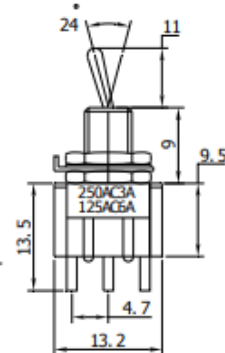
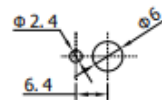

MTS-201 ON-OFF

DPST 4P

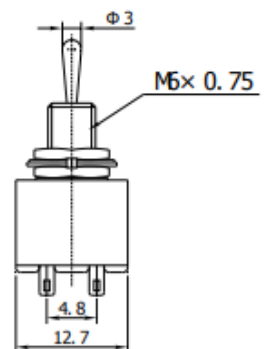
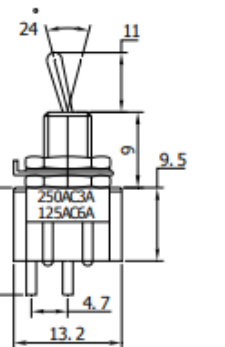
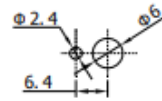

MTS-202 ON-ON

MTS-212 ON-(ON)

MTS-203 ON-OFF-ON

MTS-223 ON-OFF(ON)

MTS-223 (ON)-OFF-(ON)

MTS-2033 ON-ON-ON

DPDT 6P

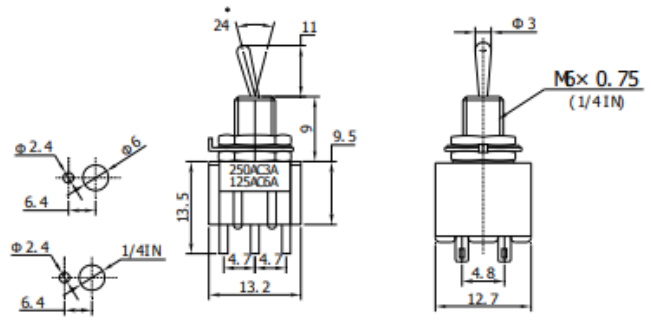

MTS-302 ON-ON

MTS-303 ON-OFF-ON

3PDT 9P

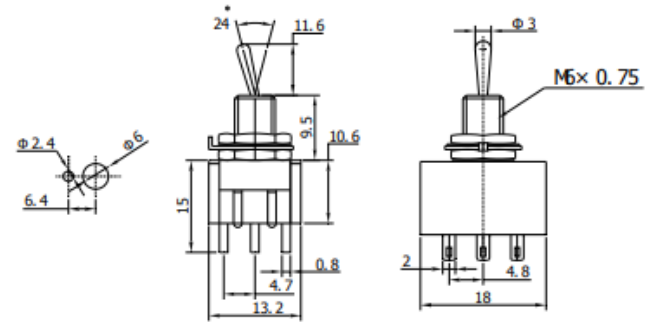

MTS-402 ON-ON

MTS-403 ON-OFF-ON

4PDT 12P

