

KFC-A06-Hn

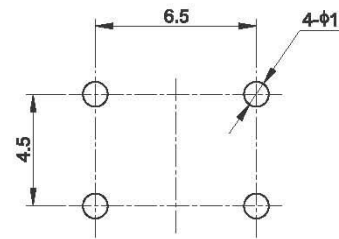

Technical parameters

Contact resistance	$\leq 100\text{m}\Omega$
Insulation resistance	$\geq 100\text{M}\Omega$
Pressure	250V AC/minute
Rated load	12V DC 0.5A
Temperature range	$-20^{\circ}\text{C} \sim +70^{\circ}\text{C}$
Motivation	According to customer requirements
Life	50000 Cycles

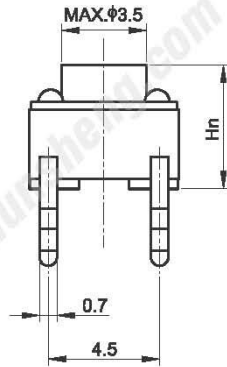
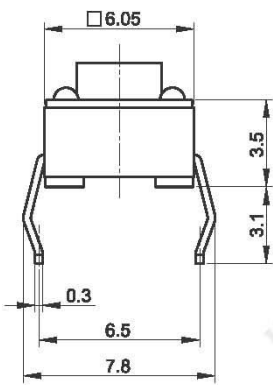

PCB LAYOUT (TOP VIEW)

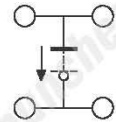

CIRCUIT DIAGRAM